

# BELVOIR!

Offers Over £385,000



## 69 Parklands Avenue

, Leamington Spa CV32 7BE

**\*\*Open House 8th of June, viewing by appointment only\*\*** Belvoir Leamington Spa are very excited to bring this beautiful family home to the market. Located on a popular tree lined avenue in North Leamington this property has been thoughtfully extended to include two reception rooms, four bedrooms and a master Ensuite. Sitting within a substantial plot, set back from the road, the rear of the property enjoys views over open countryside.

[WWW.BELVOIR.CO.UK](http://WWW.BELVOIR.CO.UK)

## ACCOMMODATION

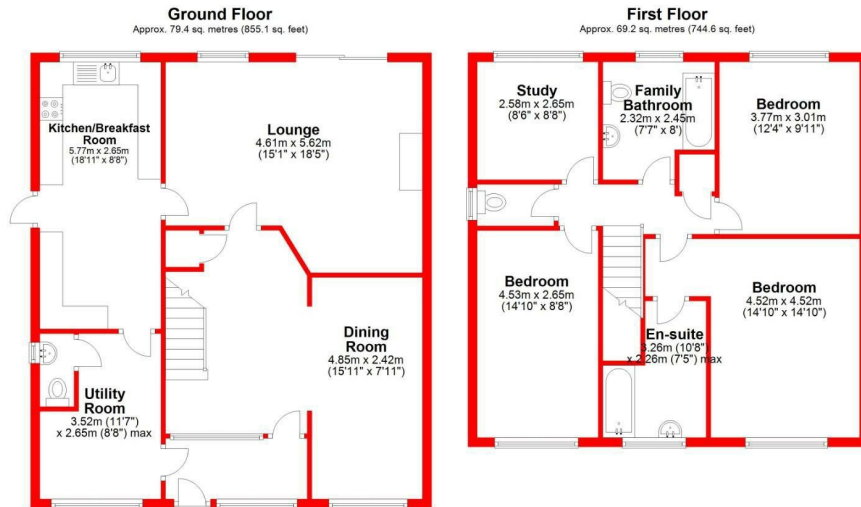

Total area: approx. 148.6 sq. metres (1599.7 sq. feet)

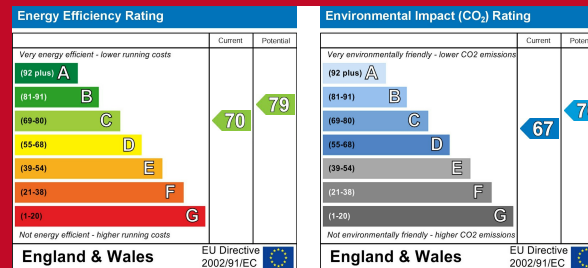

01926 422251  
22-23 Denby Buildings, Regent Grove,  
Leamington Spa, Warwickshire, CV32 4NY  
Email: amy.cunningham@belvoir.co.uk  
www.belvoir.co.uk



# BELVOIR!

IMPORTANT: We would like to inform prospective purchasers that these sales particulars have been prepared as a general guide only. A detailed survey has not been carried out, nor the services, appliances and fittings tested. Room sizes should not be relied upon for furnishing purposes and are approximate. If floor plans are included, they are for guidance only and illustration purposes only and may not be to scale. If there are any important matters likely to affect your decision to buy, please contact us before viewing the property.